

# **Texas Arc/Info Users Group**

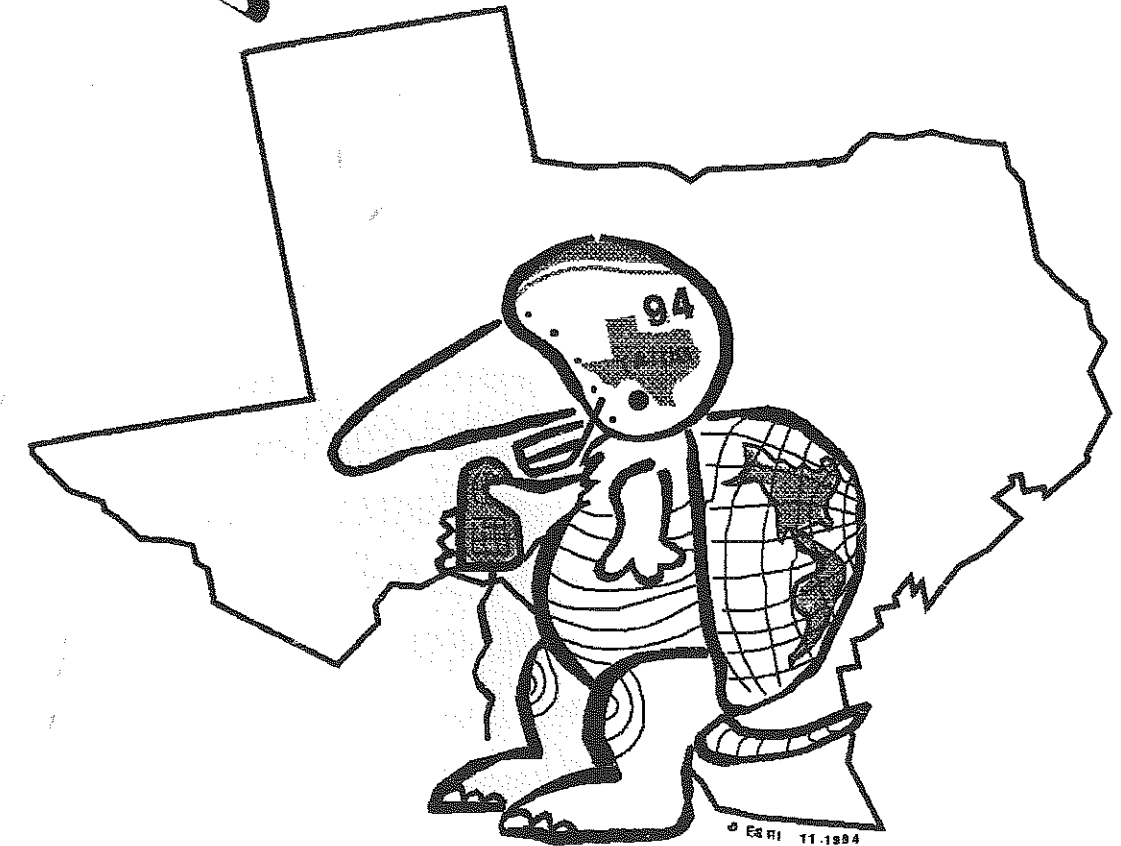

**Fifth Annual Conference  
November 14 - 18, 1994**

*Marriott Bayfront Hotel  
Corpus Christi, Texas*

## Table Of Contents

Letter From Bernie Szukalski	Page 3
Hotel Information	Page 4
Conference Center Layout	Page 5
Acknowledgements	Page 7
Conference Information	Page 8
Wednesday Events Preview	Page 11
Thursday Events Preview	Page 12
Friday Events Preview	Page 14
Presentation Schedules	
Thursday, Session 1	Page 16
Thursday, Session 2	Page 18
Thursday, Session 3	Page 20
Thursday, Session 4	Page 24
Thursday, Session 5	Page 26
Friday, Session 6	Page 28
Friday, Session 7	Page 30
University Focus	Page 32
Round Table Discussions	Page 33
Special Interest Group Meetings	Page 33
Participating Vendors	Page 22
Poster - AML - SML Ballot	Page 37

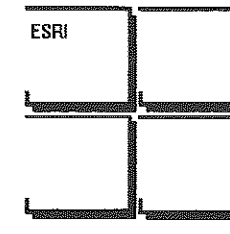

Environmental	380	Redlands	Telefax:	(909) 793-5953
Systems	New	California	Telex:	910 332 1317
Research	York	92373	Telephone:	(909) 793-2853
Institute, Inc.	Street	U.S.A.		

To The Texas Arc/Info Users:

#### CONFERENCE GREETINGS

On behalf of ESRI, and especially the ArcView Team, I am very pleased to attend this year's Texas User Group Conference in Corpus Christi. It has been an exciting year for us in Redlands, culminating with the recent releases of Arc/Info 7.0, pc Arc/Info 3.42, and the long awaited release of ArcView 2. We are very excited about these products and sincerely hope that you will be also.

It's been said too many times before but it's still true; technology is changing at an ever-increasing pace. The technological changes present all of us, both from development perspective and the user perspective, with many decisions and challenges. With these products ESRI moves in new technological directions to provide you, the users of ESRI technology, with new tools and capabilities to help you solve your problems, manage your tasks, and prepare for the future.

Part of my goal at this conference will be to listen carefully to each one of you, because it is through your input and support that we at ESRI are able to solve our technical problems, tasks, and plan ahead for future development.

In many ways the recent product releases are a direct result of your efforts to make our technology work for you, something we sincerely appreciate. It is really a partnership between the User Community and ESRI that pushes technology forward, and I am pleased at the opportunity to be here to both provide insight to ESRI's directions, and receive insight as to where we must go from here.

Have a great conference!

Bernie Szukalski



## Corpus Christi Marriott Bayfront

WELCOME! On behalf of the entire staff of the Corpus Christi Marriott Bayfront Hotel, we would like to welcome you to our hotel in the "Sparkling City by the Sea". We know you have a full agenda while you are here, but in your free time we encourage you to take advantage of the Marriott's great restaurants, fun entertainment establishments and the other guest services our hotel has to offer.

### Restaurants

The *Glass Pavilion* offers casual dining in an open air atmosphere for breakfast, lunch or dinner. Featured is a daily buffet with a Friday night special Seafood Buffet. Hours are Breakfast 6:30am - 11:30am, Lunch 11:30 am - 5 pm, Dinner 5 pm - 10:00 pm

The *Republic of Texas Bar and Grill* is Corpus Christi's newest steakhouse. It offers fine dining in a multi-level, roof top structure and is open from 3:30 pm to 10:30 pm. Happy Hour is 5:00 to 7:00.

Room Service is available from 6:30 am to 12:00 am

### Entertainment

The *High Tide Comedy Club*, located off of the lobby, features comedy shows on Thursday and Friday beginning at 7:00 pm.

### Other Hotel Services

A fully equipped health club lets you stay in shape with exercise equipment, indoor/outdoor pool, whirlpool and saunas. Racquetball courts are available for a nominal charge. Also available is access to an 18 hole championship golf course and lighted tennis courts.

### Area Attractions

131 Miles of Gulf beaches - World Class sport fishing - Corpus Christi Dog Track - Texas State Aquarium - Columbus Fleet - USS Lexington Museum

### Express Checkout

To assist conference attendees with check-out, we recommend that you use our Express Check-Out Service. You will receive this form under your door, then simply call the Front Desk at extension 148 to confirm your charges and tell them that you are checking out.

## Meeting And Conference Facilities Third Floor

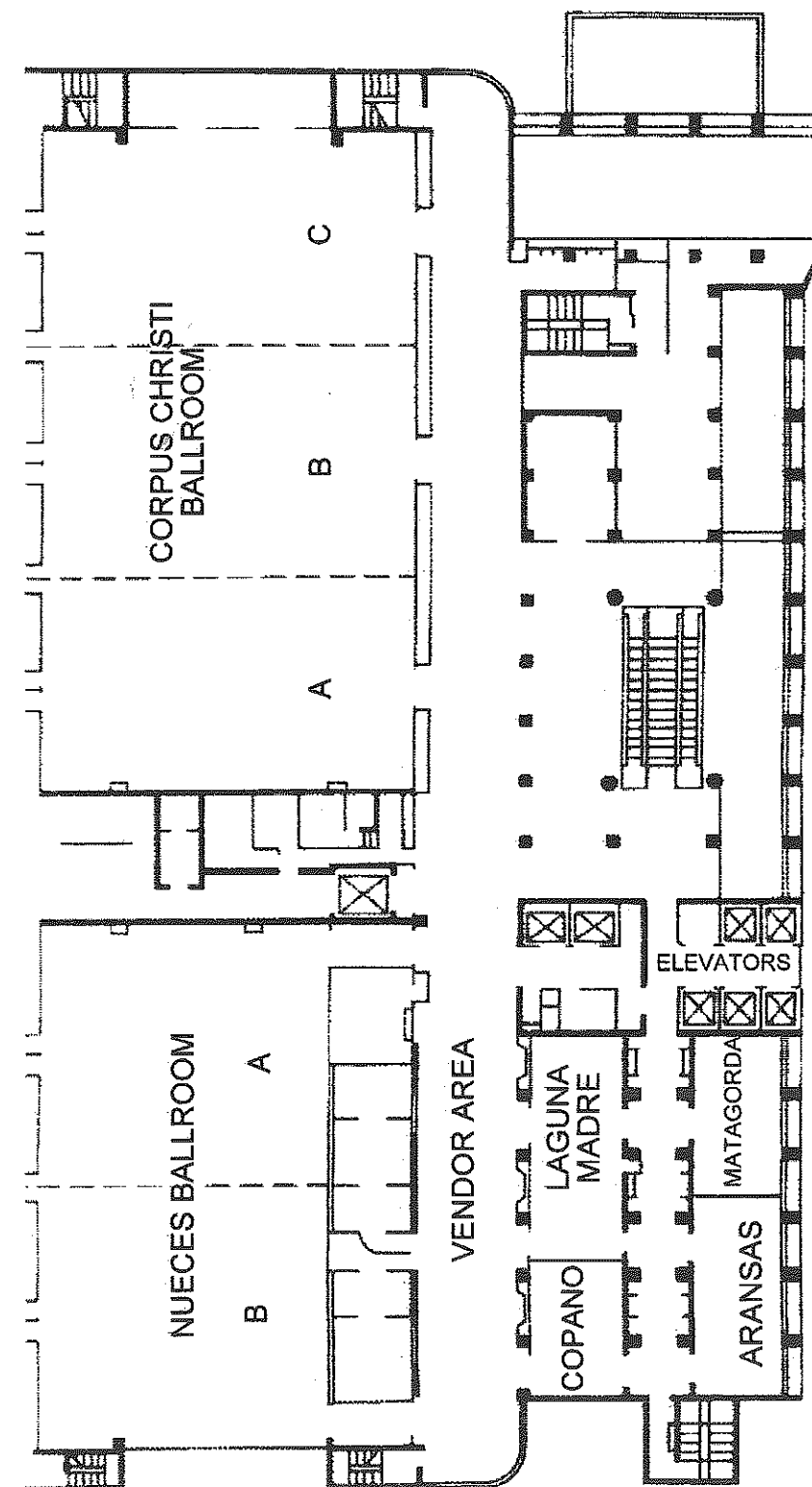

# They're Here!

## Introducing the release of **ARC/INFO® Version 7.0** and **ArcView® Version 2.0**

For years, we've dreamed of making GIS available to everyone. But we never imagined the major breakthroughs achieved by these releases. At ESRI, we have poured our hearts, your ideas, and your support into crafting two wonderful new products. We are thrilled to announce their arrival. Thank you for your ideas and support.

Sincerely,



Jack Dangermond

**We want you to make a difference with GIS.**

To order ArcView Version 2.0 or ARC/INFO Version 7.0,  
or for more information, call ESRI today at

**1-800-GIS-XPRT**  
(1-800-447-9778)



GIS by ESRI™

Copyright © 1994 Environmental Systems Research Institute, Inc. All rights reserved. ESRI, ARC/INFO, and ArcView are registered trademarks, and the ESRI globe logo, the ARC/INFO logo, the ArcView logo, and GIS by ESRI are trademarks of Environmental Systems Research Institute, Inc.

### TAIUG 1993-94 Executive Committee Members

President - Leann Gilley  
University of Texas - Tyler

Vice President - Jim Lilly  
City of Waco, Texas

Secretary - Carolyn Meanley  
The University of Houston

Treasurer - Bobby Boykin  
Washington County Appraisal District

Conference Coordinator - J. Scot Sires  
MCI Telecommunications, Inc.

Publications Coordinator - David W. Allen  
City of Euless, Texas

Membership Coordinator - Homer Riley  
Tracor Applied Sciences, Inc.

ArcMail Coordinator - Jim Hoffman  
Database Systems International

### Conference Committee

Conference Coordinator - J. Scott Sires  
David W. Allen \* Leann Gilley \* Jim Lilly  
Pam Kersh \* Lori Sullivan

### Special Thanks To The Following Organizations

MCI Telecommunications

ESRI, Inc

Geo-Info, Inc.

The University of Texas at Tyler

The City of Euless, Texas

Texas A&M University at Corpus Christi

Tracor Applied Sciences, Inc.

Washington County Appraisal District

### Great Appreciation to our Student Volunteers

Paul Sill - University of North Texas  
Pam Kersh - University of Texas at Tyler

## Conference Information

### New Attendee Orientation

This year will be the first for many of you to attend a Texas Arc/Info User's Group Conference. We invite you to make full use of the conference and attend as many of the presentations as possible. Please attend the conference business meeting if you can as there will be elections of all officers of the executive committee.

You may also want to take advantage of the facilities offered by the many vendors who are exhibiting at the conference. Nueces Foyer is reserved for vendors and they will have trained personnel in their exhibit booths to answer about the products and services they offer.

Please plan to attend the poster and AML / SML competition on Thursday night. There is a ballot in the back of this guide that you can use to select your favorite in each of the categories. Your votes will determine the winners of some very nice prizes.

If you have any needs during the conference, feel free to contact one of the conference staff or a TAIUG officer. They will help you solve your problem with great dispatch to ensure that you have a good conference experience.

### Conference Theme: GIS Is A Team Effort

The theme of this year's conference is "GIS is a Team Effort!" This theme was selected to emphasize the importance of user's working together to share information and techniques for problem solving. The sessions currently being assembled are designed to help user's interact and learn from each other's applications and to help facilitate that type of networking within the user's group. This conference also presents a unique opportunity to tap a vast resource of GIS knowledge that is present in Texas.

## Conference Information

### Meals And Refreshments

Throughout the conference we have arranged to have various meals and refreshments. Please take advantage of this courtesy as you take breaks during the sessions and for lunch. The following list will help you plan your meals and snacks to take full advantage of the offerings:

#### Monday and Tuesday

Sweet rolls, Coffee and Sodas at 7:30 am, 10:00 am, and 3:00 pm

#### Wednesday

Cookies, Coffee and Sodas at 9:50 am, 11:20 am, and 12:50 am

Chicken and Beef Quesadillas, vegetables, cheeses at 5:00 pm Reception

#### Thursday

"The Classy Way" deluxe continental breakfast at 7:00 am

Sodas and Coffee at 10:30 am

Prepared Lunches with sodas at 12:00 noon

"The Healthy Way" snacks at 4:00 pm

Mesquite Grilled Chicken Dinners at 8:00 Party

#### Friday

"The Classy Way" deluxe continental breakfast at 7:00 am

Sodas and Coffee at 10:30 am

Prepared Lunches with sodas at 12:00 noon

### Communication Center

Watch for the communications bulletin board that you may use for posting job openings, resumes, messages to other attendees, general notices and any type of information you may think of to post. In addition, incoming messages for attendees will be posted here as well as announcements of any conference schedule changes.

# Conference Information

## Special Events

### Public Service Day

Once again this year the TAIUG is sponsoring a Public Service Day in conjunction with the conference. On Wednesday morning, groups of students from area schools will be invited to the hotel for a briefing and orientation on GIS. These students represent the future of GIS and this event is always popular with them.

### GIS Bus Tour

This year's bus tour has turned out to be more of a "One Stop Shop", but well worth the trip. The facility that the group will visit is the Conrad Blucher Institute at Texas A&M University - Corpus Christi. The institute, directed by Dr. Gary Jeffries, utilizes Arc/Info in several areas such as "Geomatics", costal research and surveying. Some of their applications will be demonstrated.

The trip will leave the hotel lobby at 1:30 pm on a hotel courtesy bus or private vehicles. Participants should be back at the hotel by 3:30 pm. The trip is sponsored by TAUCC and is hosted by Pamela Kersh.

### Post-Game Party

After a hard day of GIS'ing, your invited to dinner and dancing with you GIS teammates. During this event will be your chance to vote on your favorite posters, AML's and SML's. The ballot is at the back of this guide. Go all out and meet new people, and help build team connections.

# Daily Events Preview

## Wednesday, November 16

Conference Registration		Registration Desk - Third Floor Conference Center
Public Service Activities		Matagorda
Tour Bus Departs Hotel		Front Desk / Lobby
Tour of Local GIS Site	1:30 pm	
Bus Returns to Hotel	3:30 pm	
Reception with Casual Buffet	4:30 pm to 5:30 pm	
Opening Session Keynote Address	5:30 pm to 7:30 pm	Nueces Ballroom B

Daily Events Preview

Thursday, November 17		
Conference Registration	7:30 am to 9:00 pm	Registration Desk - Third Floor Conference Center
Deluxe Continental Breakfast	7:30 am to 8:00 am	Conference Center Foyer
Breakout Sessions	8:00 am to 9:00 am	
	<i>Customizing ArcView 2</i>	<i>Matagorda</i>
	<i>Pen Based Computing</i>	<i>Copano</i>
	<i>Database Management of Ethnicity and Occupational 1910 census data for Galveston, Texas</i>	<i>Laguna Madre</i>
	<i>Mapping Your Database: Database Design of Collin County, Texas</i>	<i>Corpus Christi C</i>
Vendor Area Open	9:00 am to 7:00 pm	Nueces Foyer
Break	9:00 am to 9:30 pm	
Breakout Sessions	9:30 am to 10:30 am	
	<i>Integrating GIS with current computer systems for CAMA</i>	<i>Matagorda</i>
	<i>Using the Land Records Application</i>	<i>Copano</i>
	<i>Self Directed Work Teams Management</i>	<i>Laguna Madre</i>
	<i>Successful Geocoding Through Integrated Address Matching</i>	<i>Corpus Christi C</i>
Break	10:30 am to 11:00 am	Sodas and Coffee Available
Breakout Sessions	11:00 am to 12:00 pm	
	<i>Using ArcTools Mapper</i>	<i>Matagorda</i>
	<i>Planning, Production and Applications of Digital Orthos</i>	<i>Copano</i>
	<i>Customer Access to Appraisal District's GIS Reduces Value Protests</i>	<i>Laguna Madre</i>
	<i>How to Win Support For Your GIS and Influence Your Enemies</i>	<i>Corpus Christi C</i>

Daily Events Preview

Thursday, November 17		
Lunch	12:00 pm to 1:30 pm	Boxed Lunches and Soda Provided Conference Center Foyer
Vendor Area Remains Open	till 7:00 pm	Nueces Foyer
Afternoon Breakouts	1:30pm to 2:30 pm	
	<i>Doctor's Office</i>	<i>Matagorda</i>
	<i>GPS and GIS: Fundamentals You Must Know</i>	<i>Copano</i>
	<i>Arc/Info Regions</i>	<i>Laguna Madre</i>
	<i>TBA</i>	<i>Corpus Christi C</i>
Break	2:30 pm to 3:00 pm	
Afternoon Breakouts	3:00 pm to 4:00 pm	
	<i>Doctor's Office</i>	<i>Matagorda</i>
	<i>Civil Engineering Solutions on a GIS Data Model</i>	<i>Copano</i>
	<i>What Is ArcScan</i>	<i>Laguna Madre</i>
	<i>Baccalaureate Program in Geographic Information Science</i>	<i>Corpus Christi C</i>
Break	4:00 pm to 4:30 pm	Afternoon Snacks in the Conference Foyer
Special Interest Group Meetings	4:30 pm to 6:00 pm	Nueces Ballroom A
Vendor Area Still Open	till 7:00 pm	Nueces Foyer
Product Competition	6:30 pm to 8:00 pm	
Sponsored Party	8:00 pm to 11:00 pm	Dinner with Music and Dancing

## Daily Events Preview

### Friday, November 18

Conference Registration	7:30 am to 12:00 pm	Registration Desk - Third Floor Conference Center
Deluxe Continental Breakfast	7:30 am to 8:00 am	Conference Center Foyer
Breakout Sessions	8:00 am to 9:00 am	
	<i>Doctor's Office</i>	<i>Matagorda</i>
	<i>Historic Landscape Reconstruction</i>	<i>Copano</i>
	<i>Using ArcTools Mapper</i>	<i>Laguna Madre</i>
	<i>File Conversion and Transfer Among Multiple CADD/GIS Applications</i>	<i>Corpus Christi C</i>
Break	9:00 am to 9:30 pm	
Breakout Sessions	9:30 am to 10:30 am	
	<i>Doctor's Office</i>	<i>Matagorda</i>
	<i>Producing Product During GIS Implementation</i>	<i>Copano</i>
	<i>GIS for Better Facilities Planning</i>	<i>Laguna Madre</i>
	<i>New Dimensions &amp; New Directions for GIS</i>	<i>Corpus Christi C</i>
Break	10:30 am to 11:00 am	Sodas and Coffee Available
University Focus	11:00 am to 12:00 pm	Nueces A
Lunch	12:00pm to 1:30 pm	Boxed Lunches Provided
Round Table Discussions	1:30 pm to 3:00 pm	Nueces A
Break	3:00 pm to 3:30 pm	
General Session and Closing Remarks	3:30 pm to 5:30 pm	Nueces A
Conference Ends	5:30 pm	
No-Host Dinner	Time and Locations To Be Arranged	

# The Solution— 3D Digital Imagery!

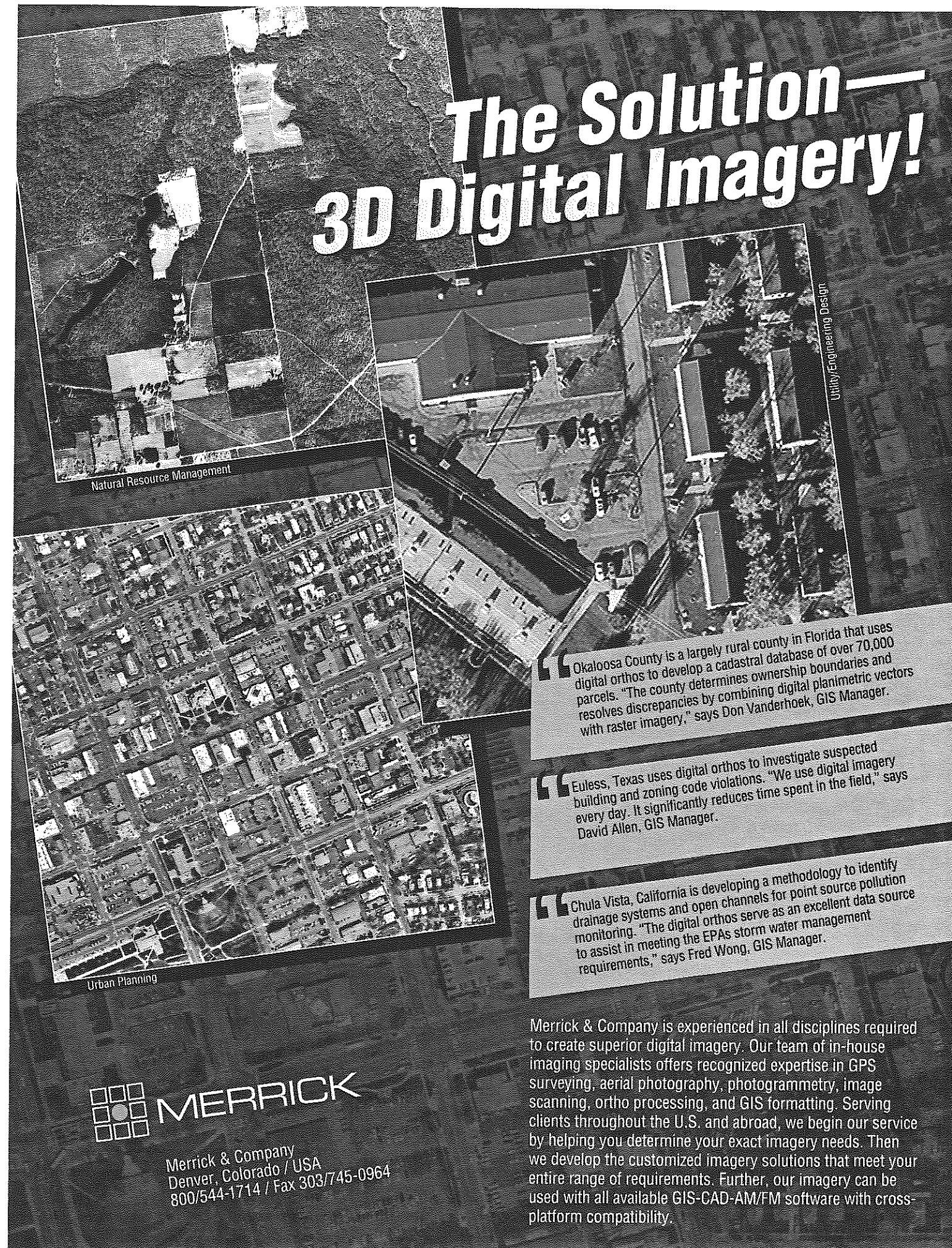

**Natural Resource Management**

**Urban Planning**

**Utility Engineering Design**

Okaloosa County is a largely rural county in Florida that uses digital orthos to develop a cadastral database of over 70,000 parcels. "The county determines ownership boundaries and resolves discrepancies by combining digital planimetric vectors with raster imagery," says Don Vanderhoek, GIS Manager.

Eules, Texas uses digital orthos to investigate suspected building and zoning code violations. "We use digital imagery every day. It significantly reduces time spent in the field," says David Allen, GIS Manager.

Chula Vista, California is developing a methodology to identify drainage systems and open channels for point source pollution monitoring. "The digital orthos serve as an excellent data source to assist in meeting the EPA's storm water management requirements," says Fred Wong, GIS Manager.

**MERRICK**

Merrick & Company  
Denver, Colorado / USA  
800/544-1714 / Fax 303/745-0964

Merrick & Company is experienced in all disciplines required to create superior digital imagery. Our team of in-house imaging specialists offers recognized expertise in GPS surveying, aerial photography, photogrammetry, image scanning, ortho processing, and GIS formatting. Serving clients throughout the U.S. and abroad, we begin our service by helping you determine your exact imagery needs. Then we develop the customized imagery solutions that meet your entire range of requirements. Further, our imagery can be used with all available GIS-CAD-AW/FM software with cross-platform compatibility.

## Presentation Schedule

Thursday Session 1 8:00 am - 9:00 am

### Customizing ArcView 2

**Bernie Szukalsi**  
ESRI, Inc. - Redlands

**Matagorda**

ArcView 2 provides many different customization capabilities. Users may customize the behavior of documents and themes by manipulating various properties and utilizing "Hot Key" functionality. Additionally Avenue, ArcView's object-oriented scripting and development environment, can be used to modify ArcViews graphical interface and extend the capabilities of ArcView through the creation of Avenue scripts.

A native of Pennsylvania and a biologist by education, Bernie Szukalski moved to Redlands, California, to accept a position working under a National Institutes of Health grant to study bone and mineral metabolism. There he stumbled onto ESRI and into a new career in GIS in 1986, when Arc/Info revision 3.0 and a Prime computer represented the 'state of the art'.

This presentation will discuss the various ways in which ArcView can be customized and present an overview of object-oriented programming within the context of Avenue. The creation of Avenue scripts will be described and the environment and other tools and utilities which compose the Avenue development environment will be discussed.

Bernie has spent two and a half years in various position at ESRI, starting with the Applications Group before moving on to the Technical Support Staff, Marketing Group, and applications Prototype Laboratory. Currently he is a member of the ArcView Product Development Team, also serving as Technical Coordinator for ArcView Developers.

### Pen Based Computing

**David Dignum**  
Jefferson County Appraisal District

**Copano**

Discussion and demonstration will be geared toward the use of pen based computers for in-the-field update of geographic data.

David Dignum has a BS degree in Forest Management (1983) and an MS degree in Forestry (1988), both from Texas A&M University. He specialized in GIS and Remote Sensing. Since 1989 he has been employed with the Jefferson County Appraisal District where he serves as a GIS specialist. He has provided consulting services for the South East Regional Planning Commission, Orange County Appraisal District, Louisiana-Pacific / Kirby Forest Industries and Jasper County Appraisal District. David also chairs the Texas Association of Appraisal Districts Methods and Technology Committee.

## Presentation Schedule

Thursday Session 1 8:00 am - 9:00 am

**Database Management of Michael Clark and  
Ethnicity and Occupational 1910 Kindness Israel  
Census Data for Galveston, Stephen F. Austin State  
Texas University, Nacogdoches, Texas**

**Laguna  
Madre**

Efficient management of data is essential for any large database analysis. The Galveston 1910 census data of occupational and ethnic information consists of thousands of hand written pages. Management of this complex dataset includes manual entry of all data into an automated database which reconstructs the data into a usable format for manipulation and analysis. AML programs written using Arc/Info read the raw data files, perform the necessary calculations for ethnicity and occupation, and output the results to a new data file. With this new data file compiled, many analysis tasks can be performed.

Michael Clark is with the Department of Political Science and Geography, and Kindness Israel is with the College of Forestry at Stephen F. Austin State University.

**Mapping Your Database:  
Database design of Collin  
County, Texas**

**Tim Nolan**  
Collin County, Texas

**Corpus  
Christi C**

GIS constitutes a framework in which to develop data standards, enhance the sharing of information and provide more efficient operation through the reduction of redundant data maintenance procedures. A database design helps us to "map" this framework.

The discussion will focus on general goals established by Collin County and how a database design is used to satisfy our needs. It will also touch on the database design concepts, implementation process and the data dictionary. The overall objective of a database design is to have a comprehensible document that describes how data resides in a system and the approach necessary to utilize that information

Tim Nolan received his B.A. in Geography from the University of North Texas in 1991. Prior to graduating, he was a teaching and research assistant in the Department of Geography and served a brief stint as the "whipping boy deluxe" for the Center for Remote Sensing and Landuse Analysis (CRSLA). For the past two and a half years, Tim has been involved in creating a working GIS that is serviceable to many county-wide departments. Most recently, he has been responsible for establishing Collin County's GIS student internship program.

## Presentation Schedule

Thursday Session 2 9:30 am - 10:30 am

### Integrating GIS with Current Computer Systems for CAMA

**Melinda Polley**  
Ellis County Appraisal District

**Matagorda**

This presentation will discuss the problems and solutions associated with moving your manual mapping system to full GIS implementation. Discussion will include bringing your manual system to a close, getting your staff trained to a workable, operational level, and integrating your existing external database with your geographic dataset.

Melinda Polley is currently employed with the Ellis County Appraisal District in Waxahachie as the GIS Coordinator. She received her Bachelor of Science degree in 1989 at the University of Texas, Tyler. Since then, she has worked at the Smith County Appraisal District before accepting her current position. She is currently completing the parcel land base for the county which will soon be integrated with the Mass Appraisal System.

### Using the Land Records Application

**Jennifer Montano**  
ESRI, Inc. - San Antonio

**Copano**

The Land Records application is designed to give you a method of maintaining your parcel database. Existing parcel records and their associated graphics can be manipulated using these tools and the user interface allows novice users to better access the data. This presentation will discuss further details of the Land Records Application.

Jennifer A. Montano has a Masters of Public Administration from the University of Texas at Tyler. She joined ESRI-San Antonio in May of 1993. Jennifer focuses her efforts on appraisal districts, local governments and environmental markets.

The Office of Research Services at the University of Texas at Tyler was Jennifer's previous employer where she worked as a GIS Lab Technician. While there she gained experience in a variety of projects including parcel mapping and school boundary studies.

## Presentation Schedule

Thursday Session 2 9:30 am - 10:30 am

### Self Directed Work Team Management

**J.Scott Sires**  
MCI Telecommunications

**Laguna  
Madre**

This presentation will discuss a new trend in GIS team building that puts each GIS professional in their own self controlled team setting and allows them to interact with other GIS teams.

Scott Sires is such a unique specimen in the world of GIS that words fail me in describing his capabilities. (maybe next time he'll submit a bio)

### Successful Geocoding Through Integrated Address Matching

**Tom Hewlett**  
North Central Texas Council Of  
Governments (NCTCOG)

**Corpus  
Christi C**

Geocoding is a useful tool for determining the geographic locations of addresses. Geocoding also involves more than the entering of a few commands. Successful address matching requires the integration of address correcting and standardization tools, accurate and multi-layered coverages, reject processing techniques, and quality control methods.

This presentation relates the address matching experience gained through a regional travel survey project at the NCTCOG. Address correction using commercial mailing list software, geocoding to street centerline and ZIP+4 centroid coverages, error checking, and default coding will be discussed. These techniques will help users avoid the many traps of address geocoding.

Tom Hewlett earned his B.A. in geography at the University of North Texas in 1989. While attending college, he worked as a Geographic Assistant for the Census Bureau and then as a Research Assistant for the Geography Department at UNT. He has been with the NCTCOG since 1990. His current responsibilities include developing GIS tools and spatial data products for regional users. In addition, Tom is an Adjunct GIS Instructor at the University of Texas at Arlington.

## Presentation Schedule

Thursday Session 3 11:00 am - 12:00 am

### What is ArcTools Mapper?

The ArcTools mapper provides a menu system to create and edit map layouts. It treats each map element as a separate object and provide much of the same mapping functionality as Arc/Info and ArcPlot. It also permits new users to quickly begin creating map products.

**Cecil H. Lamb**  
ESRI, Inc. - San Antonio

**Matagorda**

Cecil H. Lamb received a Bachelor of Arts in Geography from the University of Buffalo, New York, in 1986. He has been with the ESRI-San Antonio office since September of 1992. Although his focus is technical marketing, Cecil is also involved in technical support and application programming.

Cecil previously headed the System Support Unit for the New York State Department of Transportation's Mapping and GIS Bureau where he was responsible for GIS research and development.

### Planning, Production and Applications of Digital Orthos

**Gary Outlaw**  
Merrick & Co.

**Copano**

This presentation will focus on planning and producing digital orthophotography for GIS applications. Discussions on flight planning, survey coordination, digital elevation models, scan resolutions and ortho rectification procedures will be discussed. Additionally, hear how other local governments, federal agencies and private organizations are utilizing this new GIS coverage.

Gary Outlaw has been with Merrick & Co. since June of 1990 and currently manages all business development activities for Merrick's GIS Surveying and Mapping Division. Gary has been involved with AM/FM/GIS solutions for private and public agencies since 1985. He holds a Bachelor and Masters of Business Administration from the University of Texas.

## Presentation Schedule

Thursday Session 3 11:00 am - 12:00 am

### Customer access to District's GIS reduces value protests

**Kurt Menking**  
Bexar Appraisal District

**Laguna**  
**Madre**

The Bexar Appraisal District has implemented a new Customer Query System (CQS) to allow staff and customers access to the District's GIS information. This talk will discuss what the CQS is, what it does, how it works and other details of its implementation. Then the benefits to the customers, staff and the public will be outlined. Finally, a summary of the results of the first year of operation

Kurt has worked for the Bexar Appraisal District as the Geographic Information Systems Manager. He previously worked for Furgeson Map Company, and spent 9 years with Petroleum Information in their GIS department. Kurt has a Bachelors Degree from Southwest Texas State University.

### GIS Networking -How to win GIS Support and influence enemies

**Leann Gilley**  
University of Texas - Tyler

**Corpus**  
**Christi C**

Combining existing resources in Tyler to develop effective GIS networking has aided in the development of local projects; one of which was the Tyler Independent School District plan. An efficient, productive, and cost saving GIS was developed by combining existing information from the 911 Network of East Texas, the City of Tyler and the school district. The result is a database that not only benefits the school system but could also benefit other public and private entities.

Leann Gilley, the current TAIUG President, holds a Bachelor's of Applied Arts and Sciences in Technology from the University of Texas, Tyler, and an Applied Arts and Sciences Degree in Land Surveying Technology from Tyler Junior College. Ms. Gilley is the president and principle owner of Geo/Info, Inc., a full service GIS applications development firm and is associated with the GIS Research Lab at the University of Texas, Tyler.

During this presentation, expect a discussion of the details involved in the Tyler ISD project, recent project developments, and lessons learned for future projects. Also discussed will be how to use the needs of others to promote your own GIS program. "GIS Networking" can be the platform from which to launch much needed support within your organization.

The TAIUG would like to extend a special thank you to the vendors who have supported this conference. Their efforts on our behalf are greatly appreciated.

**ESRI, Inc.**

**Trimble Navigation**

**Merrick & Co.**

**Geo-Info, Inc.**

**Half & Associates**

**Calcomp**

**Crowell Automated Design**

**Data General Corp**

*The new GPS ProLite—  
digital data collection in  
the field for ARC/INFO.*



# TRIMBLE GPS FOR FAST, ACCURATE FIELD INPUT FOR YOUR ARC/INFO® DATABASE.



**T**rimble GPS mapping systems provide a quick, efficient way to collect GIS data in the field and seamlessly transfer it to your ARC/INFO database. Our GPS Pathfinder™ mapping systems enable you to record accurate position and feature data in the field and store that information directly to a digital format for use with ARC/INFO.

Trimble GPS Pathfinder mapping systems are rugged, field-proven data collection tools for recording geographic information on the ground, in the air or on the water. A range of systems is available to suit your specific budget and accuracy requirements, including lightweight handheld models and systems with sub-meter accuracy.

For optimum efficiency, Trimble's PFINDER™ software converts collected GPS field data for a

seamless transfer to ARC/INFO, saving you time and money on data conversion.

Seamless means your field data is automatically converted to ARC/INFO formats that include the proper file extensions for transferring the data to the appropriate coverage.

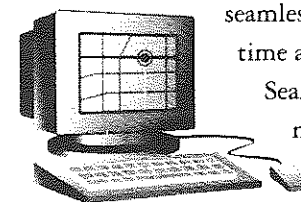

*All Trimble GPS mapping  
systems transfer your field data  
to ARC/INFO formats.*

PFINDER software automatically creates ARC/INFO macro files, downloads polygons with automatic point labeling and also generates new coverages based on feature names you record in the field. Descriptions are easily predefined in the office using PFINDER software, so that out in the field, recording data is as simple as waving a barcode reader or pressing a button.

If you need a quick, efficient way to enter data to and update your ARC/INFO database, try out a Trimble GPS Pathfinder system—GPS that speaks ARC/INFO. For more information about GPS data collection for ARC/INFO systems, call us today.



**Trimble**

*The Leader in GPS Solutions.*  
Surveying & Mapping Systems  
645 North Mary Avenue  
Sunnyvale, CA 94086  
1-800-827-8000 in the U.S. & Canada  
+1 (408) 481-8000  
FAX: +1 408-481-7744  
Trimble Europe +44 256-760150  
Trimble Singapore +65 738-6549

## Presentation Schedule

Thursday Session 4 1:30 pm to 2:30 pm

### Doctors Office

Got a problem? Not sure how a particular feature could be used to make your job easier? Here's your chance to get all the answers from the people that know Arc/Info and all of the ESRI products the best. Stop by at any time during this sessions and talk with one of the GIS "Doctors" on hand.

### ESRI Technical Staff

### Matagorda

### GPS in GIS: Fundamentals You Must Know

### Stephan S. Mock, Sr. Trimble Navigation

### Copano

This presentation will help give the attendee a "working concept" of GPS fundamentals including:

Applications of GPS  
The Navstar GPS Satellite System  
Obtaining Positional Data  
Processing GPS Data  
Bi-Directional transfer of GPS data to a GIS

Types of Receivers  
Accuracies  
Mission Planning  
Field Operation of GPS Receivers

Stephan Mock holds a B.S. Degree in Computer Sciences from Stephen F. Austin University and has worked with various GPS products and softwares. His greatest involvement with GPS has been with Trimble while compiling survey data for "field to finish" projects.

## Presentation Schedule

Thursday Session 4 1:30 pm to 2:30 pm

### Regions in Arc/Info Ver. 7.0

Arc/Info version 7.0 contains updates in many areas, including additions of a new feature class called Regions. This presentation will concentrate on the following:

What are Regions?  
What is the purpose for Regions?  
How do you create Regions?  
How do you manipulate and edit Regions?  
How do you use them in queries and analyses?

The presentation will include details on the command reference and a brief demonstration.

### Shelia Sullivan-Weems ESRI, Inc. - San Antonio

### Laguna Madre

Shelia has over 8 years of computer services experience. She joined the ESRI - San Antonio team approximately three years ago, primarily as a workstation Arc/Info trainer. Over time she transitioned from trainer to technical marketer and support person concentrating heavily on local government. Presently she serves as the Regional Manager in the San Antonio office, supervising a growing office of ten GIS professionals. She is responsible for supporting local users and for providing marketing services to potential clients in Texas, Louisiana, Mississippi, Oklahoma and Puerto Rico.

Prior to joining ESRI, Shelia was employed by Landata, Inc., of Houston. As one of an original two member team hired to implement PC Arc/Info, she

### Topic And Presenter To Be Arranged

### Corpus Christi C

Presentation Schedule

Thursday Session 5 3:00 pm to 4:00 pm

Doctors Office - Continues ESRI Technical Staff Matagorda

Got a problem? Not sure how a particular feature could be used to make your job easier? Here's your chance to get all the answers from the people that know Arc/Info and all of the ESRI products the best. Stop by at any time during this sessions and talk with one of the GIS "Doctors" on hand.

Civil Engineering Solutions on a Dave Totten Copano  
GIS Data Model Plus III Software, Inc.

Many people within the GIS community are proponents for making the GIS data model the information and solution center for the enterprise. With a wide variety of users making up the enterprise, one size fits all becomes a difficult if not impossible task for any data model to accommodate. Dave Totten, Vice President of Plus III Software, Inc., has a bachelor of Sciences in Civil Engineering from the University of Florida. He was marketing manager for GIS and Engineering solutions for Data General Corp. He also has had his own systems integration business specializing in Spatial Information Systems prior to joining Plus III. He now heads up the GIS Division of Plus III Software, Inc.

Users who have access to this information need a view of the data that is consistent with their particular view of the world. Civil Engineers that are involved in site development, hydrology, land fill, road design or other infrastructure management see the world as a 3D land model and need a 3D land data model to design and analyze their 3D sites, roads, pipes and slopes.

In order to make civil engineers within the enterprise happy with the GIS data model, 2D data models with valuable information must somehow be able to store and/or be transformed into a 3D land model. This 3D land model can then be used to design sites, roads and highways, mines, landfills, sewers as well as many other types of analyses.

Presentation Schedule

Thursday Session 5 3:00 pm to 4:00 pm

What Is ArcScan? Chitra Subramaniam Laguna  
ESRI, Inc. - San Antonio Madre

ArcScan is Arc/Info's new raster editor and raster-to-vector conversion package. ArcScan is designed to help you build vector databases using scanned raster images as input. With ArcScan, you can take a scanned image, align it to a map coordinate system, correct any errors in the image, remove unwanted features or noise, then extract the raster lines to create an Arc/Info Coverage.

Chitra Subramaniam received a Master of Applied Geography in Geographic Information Systems / Cartography in 1991 and a Bachelor of Business Administration in Computer Information Systems in 1988 from Southwest Texas State University in San Marcos. She has been employed at ESRI-San Antonio since February of 1993.

Prior to joining ESRI, Chitra presided as the Chairperson of the Texas GIS Standards Committee for the Department of Information Resources in Austin. She was responsible for coordinating the GIS standards effort for the State of Texas which included the development of the publication "Standards and Guidelines

Baccalaureate Program In Dr. Gary Jeffres Corpus  
Geographic Information Science Dr. Katherine H. Price Christi C  
Conrad Blucher Institute  
Texas A&M University - Corpus Christi

Numerous employment opportunities and a strong demand for professionals in the areas of GIS and Professional Land Surveying in Texas prompted the design of a new undergraduate program in Geographic Information Science a Texas A&M University - Corpus Christi. The program is being planned by faculty, researchers, an active member of the surveying profession, and a senior GIS manager in a Texas government agency. This team assembled data on historical employment and student requirements for presentation to and approved by the Texas Higher Education Board.

Gary Jeffres holds a Ph.D., M.S., and B.S. in Surveying Sciences and Surveying Engineering. He is the Director of Geographic Information Science at the Conrad Blucher Institute.

Katherine Price holds a Ph.D, M.A., and B.A. in Physical Geology and Geography. She is an Adjunct Professor of Geology for TA&MUCC and a Research Scientist for the Conrad Blucher Institute.

This session will describe the philosophy of the degree program and will host a discussion on GIS education at the university level.

Presentation Schedule

Friday Session 6 8:00 am to 9:00 am

Doctors Office - Continues ESRI Technical Staff Matagorda

Got a problem? Not sure how a particular feature could be used to make your job easier? Here's your chance to get all the answers from the people that know Arc/Info and all of the ESRI products the best. Stop by at any time during this sessions and talk with one of the GIS "Doctors" on hand.

Historic Landscape Paul R. Blackwell and Michael Copano  
Reconstruction Clark  
La Nana Creek Watershed, Stephen F. Austin State  
Nacogdoches, Texas University

La Nana creek is a culturally rich landscape which represents an important asset to the people of East Texas. In an effort to appreciate the historical significance of this area, historical landscape reconstruction was undertaken using GIS techniques to recreate the topography of the La Nana Creek watershed as it existed prior to landscape alterations stimulated by local and federal interest in flood control. Methodologies included manual digitization of topographical maps and aerial photo series from the 1940's and 1950's. These data were used to create a Triangulated Irregular Network (TIN) from which a rasterized representation (LATTICE) of the landscape was produced. The raster layer was further manipulated resulting in a reconstructed morphologic landscape theme for the La Nana Creek Watershed

Paul Blackwell and Michael Clark are with the Tucker Center, College of Forestry, Stephen F. Austin State University in Nacogdoches, Texas.

Presentation Schedule

Friday Session 6 8:00 pm to 9:00 pm

What is ArcTools Mapper? Cecil H. Lamb Laguna  
ESRI, Inc. - San Antonio Madre

The ArcTools mapper provides a menu system to create and edit map layouts. It treats each map element as a separate object and provide much of the same mapping functionality as Arc/Info and ArcPlot. It also permits new users to quickly begin creating map products.

Repeat of Thursday at 11:00 am.

Cecil H. Lamb received a Bachelor of Arts in Geography from the University of Buffalo, New York, in 1986. He has been with the ESRI-San Antonio office since September of 1992. Although his focus is technical marketing, Cecil is also involved in technical support and application programming.

Cecil previously headed the System Support Unit for the New York State Department of Transportation's Mapping and GIS Bureau where he was responsible for GIS research and development.

A Study of file conversion and transfer among multiple CADD/GIS applications across multiple hardware platforms Chester Helt Corpus Christi C  
Halff Associates, Inc.

This presentation is a study of file conversion between an Intergraph / Bentley Microstation application and ESRI's workstation software. An intensive analysis of the IGDS export/import in Arc/Info is covered as well as file import and export from several distinct sources.

Chester Helt holds a Bachelor's of Science in Physics from Oklahoma State University (1974) and a Masters of Science in Physice from Central State University (1984). He has worked for Public Service Co. of Oklahoma, C.H. Guernset & Co. Southwest Electric Co. and currently holds a position with Halff Associates, Inc.

Presentation Schedule

Friday Session 7 9:30 pm to 10:30 pm

Doctors Office - Continues ESRI Technical Staff Matagorda

Got a problem? Not sure how a particular feature could be used to make your job easier? Here's your chance to get all the answers from the people that know Arc/Info and all of the ESRI products the best. Stob by at any time during this sessions and talk with one of the GIS "Doctors" on hand.

GIS for Better Facilities Planning Leann Gilley University of Texas - Tyler Laguna Madre

The Tyler Independent School District (TISD) expressed a desire to study their school facilities using GIS for the purpose of determining future facility needs based on current and projected enrollment figures. TISD administrators utilized an Arc/Info generated school attendance application to examine the spatial relationships between students and facilities on a street network coverage of the area. This allowed them to identify schools which were under or over utilized according to student populations. By examining other demographic statistics such as racial and ethnic make-up, TISD administrators then identified ways in which to readjust attendance zone boundaries while still adhering to court mandated desegregation guidelines. As a result, school district officials have recognized a need to close several older facilities in favor of newer ones which will better accommodate future student populations.

Leann Gilley, the current TAIUG President, holds a Bachelor's of Applied Arts and Sciences in Technology from the University of Texas, Tyler, and an Applied Arts and Sciences Degree in Land Surveying Technology from Tyler Junior College. Ms. Gilley is the president and principle owner of Geo/Info, Inc., a full service GIS applications development firm and is associated with the GIS Research Lab at the University of Texas, Tyler.

Presentation Schedule

Friday Session 7 9:30 pm to 10:30 pm

Producing Product During Ron L. Reynolds Copano  
Implementation of GIS City of Plano

This presentation will discuss our Ron holds Bachelors and Masters experiences with producing map products Degrees in City and Regional Planning during the implementation of our GIS. from the University of Texas - Arlington. Primary focus will be on a small press run He interned at the City of Euless before of the City of Plano Zoning Atlas. The accepting his current position of two and process will be followed through from a half years with the City of Plano. design stage, finding a printer, to prepress and the final product.

New Dimensions & New Robert W. Redding Corpus  
Directions for GIS Plangraphics, Inc. Christi C

Change is taking place in business and Robert Redding joined PlanGraphics in industry at an ever increasing pace. 1994 after having been the Arc/Info "Fuzzy Logic" is the name of a technology system administrator for Fairfield that provides a way to recognize and deal Digitizing Services in Houston. He is now with the real events associated with a senior research analyst working out of change. If built into a system, fuzzy logic the Western and Pacific Regional technology can make the system respond Consulting Group in San Antonio. This to its environment, and make adjustments office supports PlanGraphics clients in that keep the system pursuing a goal the Western U.S., Mexico and Central way human beings would. America. His background is n project management, AM.FM/GIS

Where does GIS fit into this picture? GIS implementation and new technology integrates. We know it as a system that integration. Robert has a Bachelor of integrates spatial data management with Science in Geography and a Master of networking and area analysis. But it really Agriculture, Natural Resources integrates a host of very different things - Development from Texas A&M people, technology and work process. GIS University. provides the digital information infrastructure that enables many systems to be integrated into the work process, but primarily it integrates people with information.

Properly integrated, GIS will aid in system integration and give the user the tools to excel.

## University Focus

TAIUG will present the Second Annual GIS Education Competition on Friday, November 18 from 1:30 to 4:00 pm. Two papers will be presented in this year's competition. Pamela Kersh will represent the University of Texas at Tyler with her paper, "GIS as an Environment Planning and Resource Management Tool for Urban and Regional Planners". Richard Lawrence, Ernest Fish, and S. Demaris will represent Texas Tech University with a paper titled, "Automated Wildlife Home Range Data Collection and Analysis with PC Arc/Info."

The Staff Of  
**GEO/INFO, INC.**  
Your Best Source For Professional  
ARC/INFO GIS Services  
**CONGRATULATES TAIUG**  
On A Successful Conference  
And Wishes Everyone  
*A Happy Holiday Season*  
**GEO/INFO, Inc.**

777 S. Broadway, Suite 201  
Tyler TX 75701 • 903-592-4473

*A Special Thanks to Geo-Info, Inc.  
for Co Sponsoring Thursday's  
Continental Breakfast*

## Special Meetings

### Round Table Discussions

This event involves attendees going to a topic table of their choice and discussing that topic for 15 minutes, then rotating to another topic table. The topics and table hosts are:

UNIX - Cecil Lamb  
PC Arc/Info - Leann Gilley  
ArcView 2 - Bernie Szukalski  
ArcPlot - Jennifer Montano  
ArcEdit - Chitra Subramaniam  
AML - Sheila Sullivan-Weems  
GPS - John Beadles

### Special Interest Groups

After several rounds of the previous software oriented topics, the topics and hosts will change to SIG related topics. These will be:

Transportation - Cecil Lamb  
Appraisal Districts - David Dignum  
911 - Jan Funderburgh  
Municipal Government - Jennifer Montano  
County Government - Tim Nolan  
State Government - Chitra Subramaniam

